

An inventive design that perfectly  
complements the splendid façade of  
**Bahu Fort**



# Our Vision with the Show

Our concept revolves around creating an immersive experience that transcends the conventional Son-et-lumiere approach. At its core, we've transformed the Bahu Fort wall into the focal canvas for our projection. Harnessing the power of projection mapping and façade lighting, we've strategically illuminated the fort's majestic burj's, harmonizing their color palettes with the content displayed. To further immerse our audience, we've meticulously installed a state-of-the-art 5.1 Surround Sound setup, ensuring that every sight and sound intertwine to offer a truly captivating encounter at Bahu Fort.



# Remarkable results with few additions to the BOQ provided in the tender

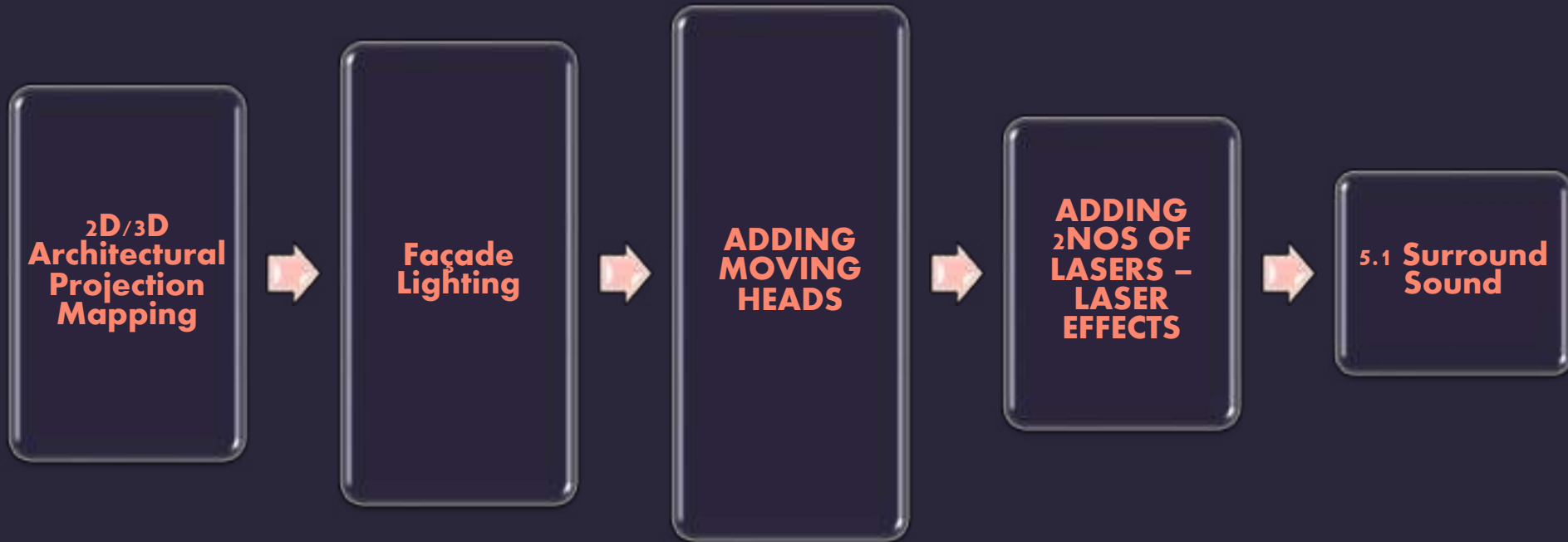

# LAYOUT DESIGN



# BAHU FORT

# Façade Layout

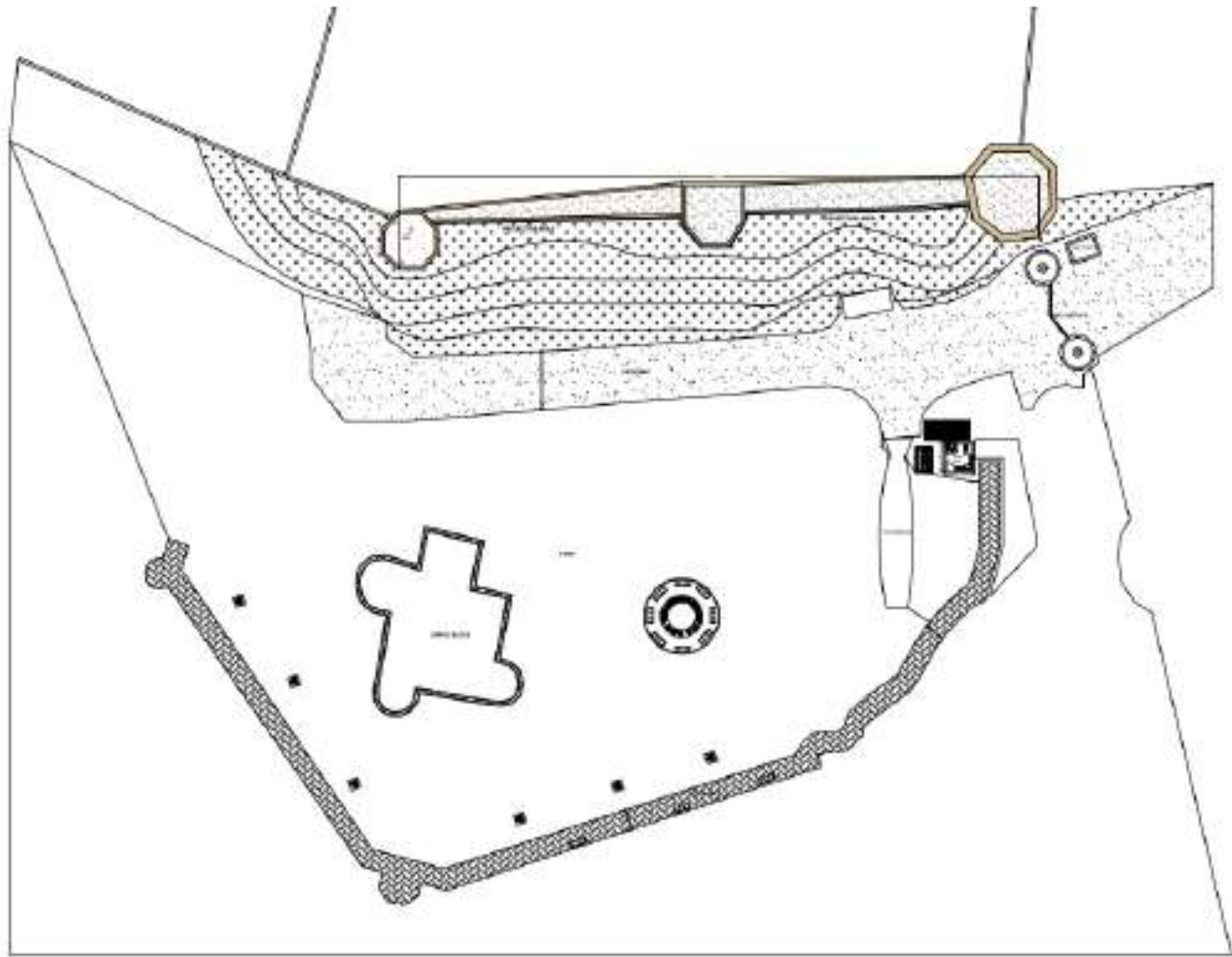

# Equipment Placement Layout

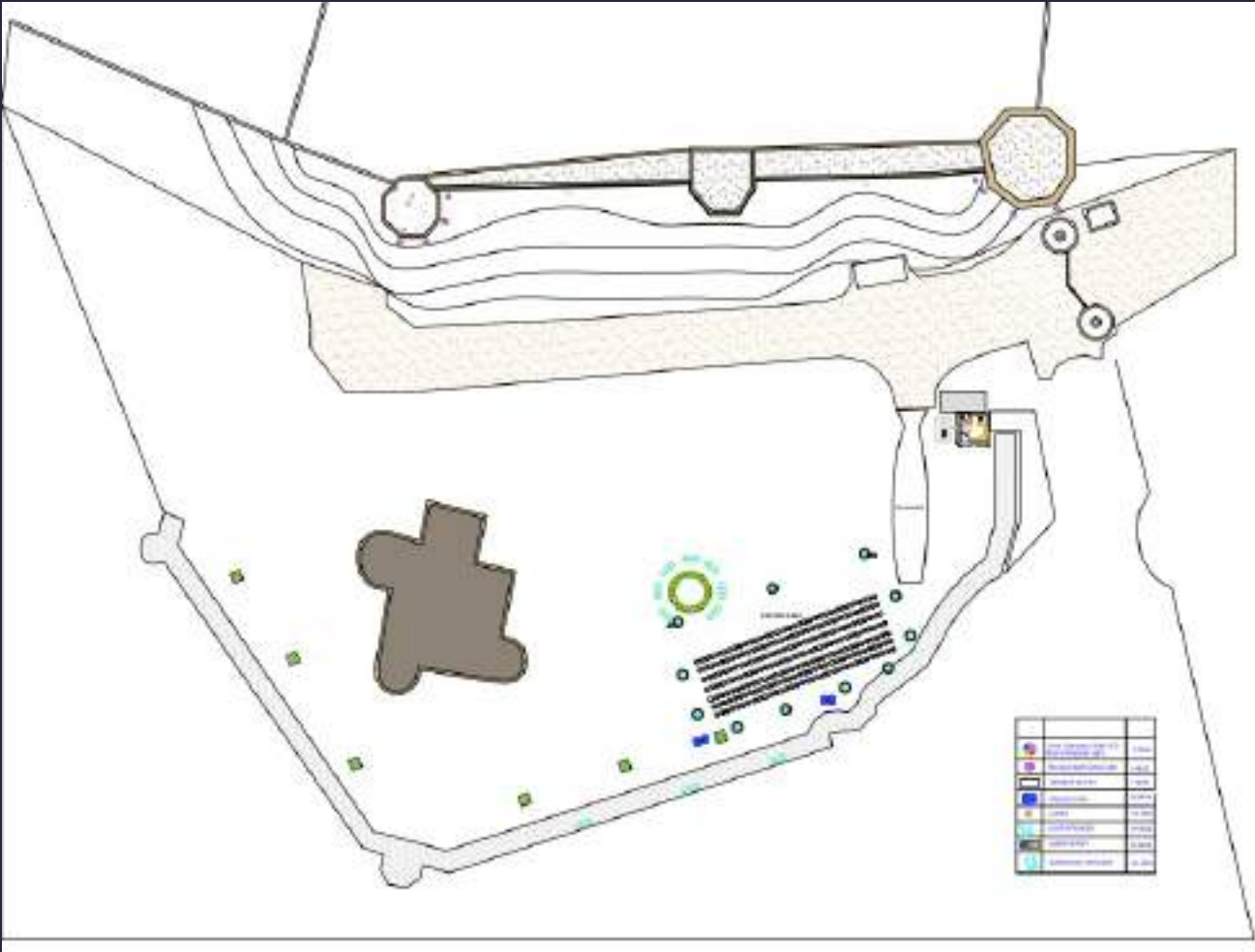

# Projection Plan

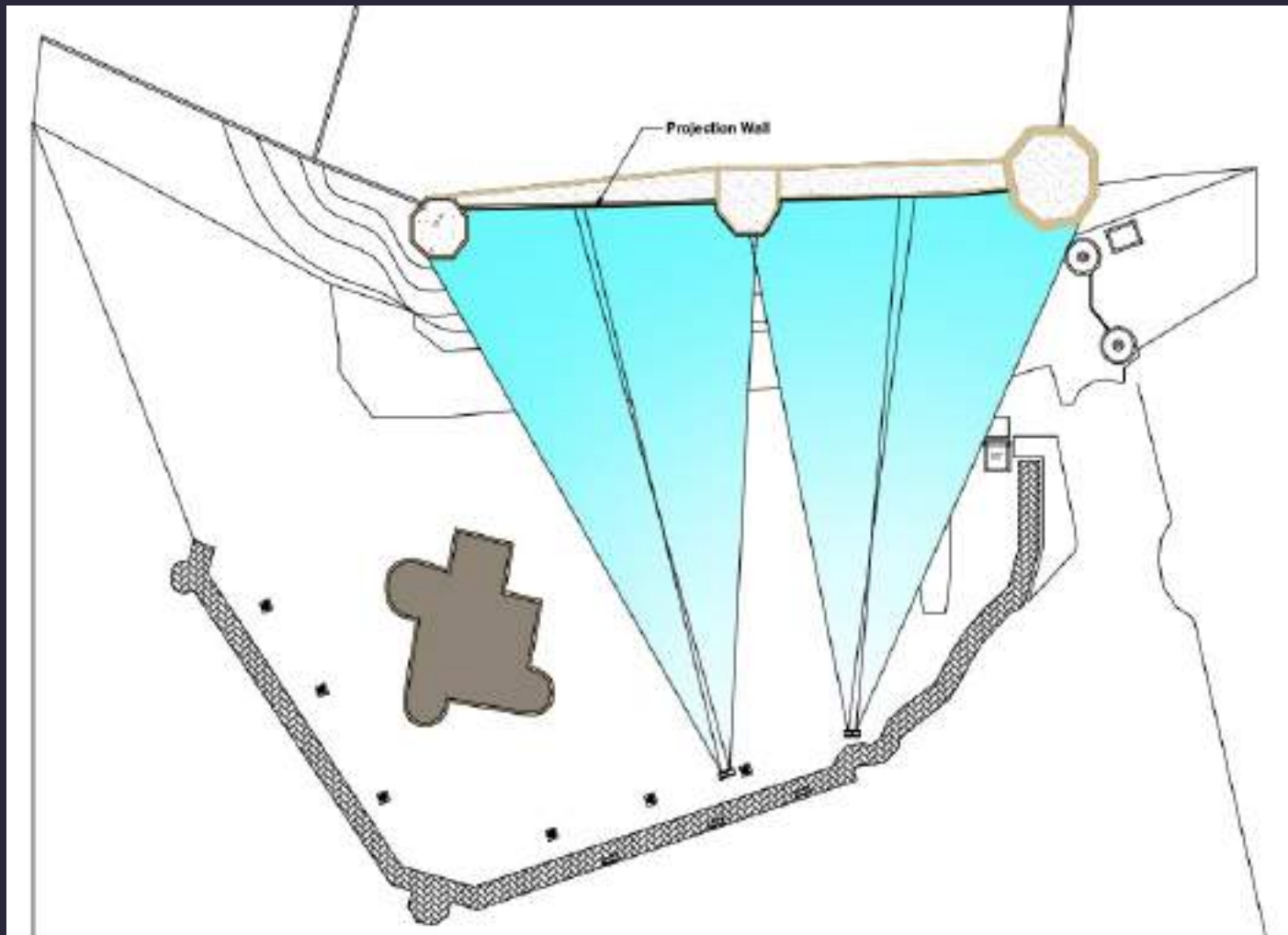

# Seating Area & Control Room Plan

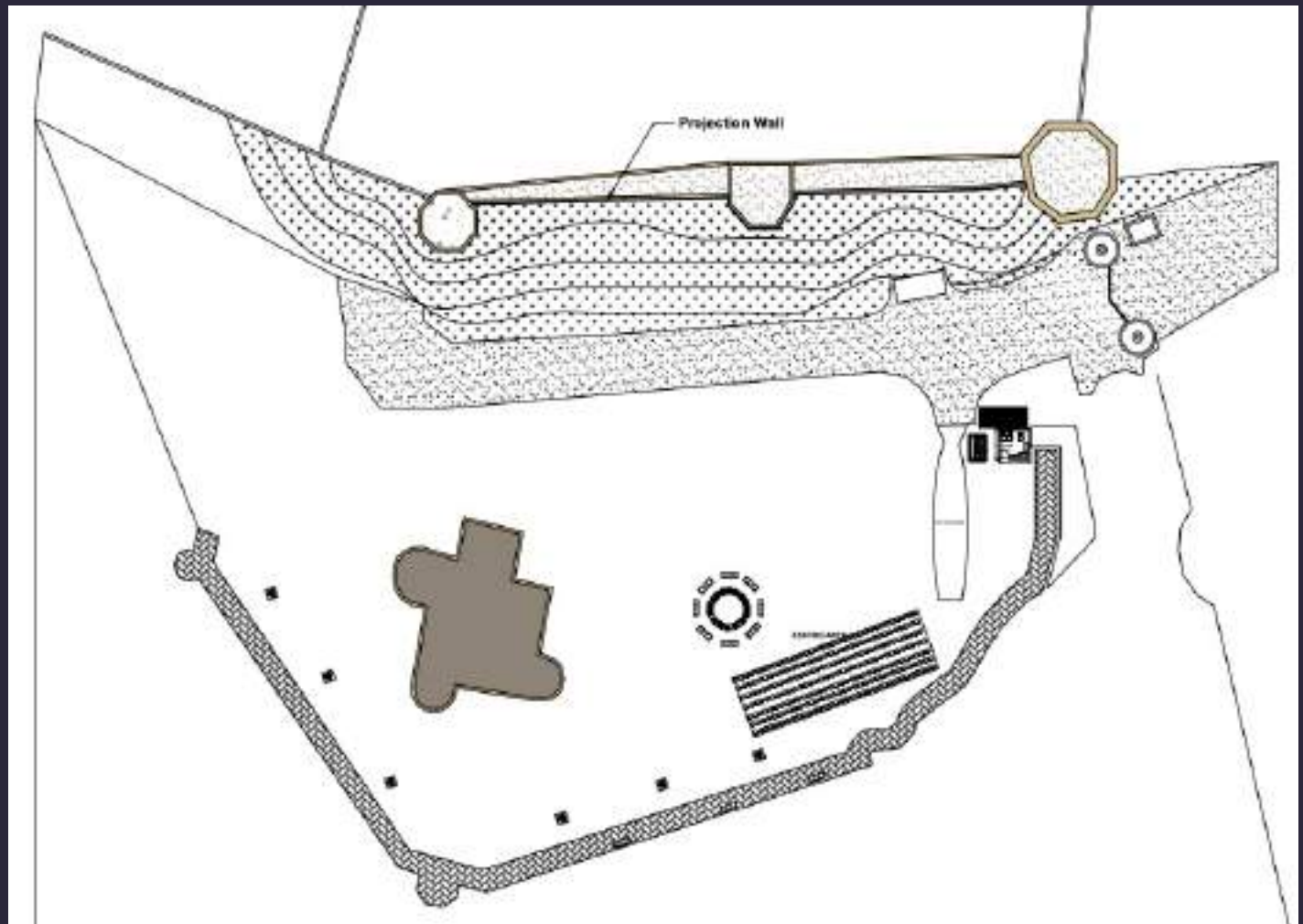





To expand the coverage area beyond the NIT's proposed limits and seamlessly integrate our projection with the illumination, we've employed four projectors. This strategic approach not only ensures uniformity but also amplifies the overall scale of the projection.



**PROPOSED PROJECTION AREA AS PER NIT  
APPROX 40ft (H) X 160ft (W)**

**THE PROJECTION AREA AS PER OUR VISION  
APPROX 37.5ft (H) X 234ft (W)**

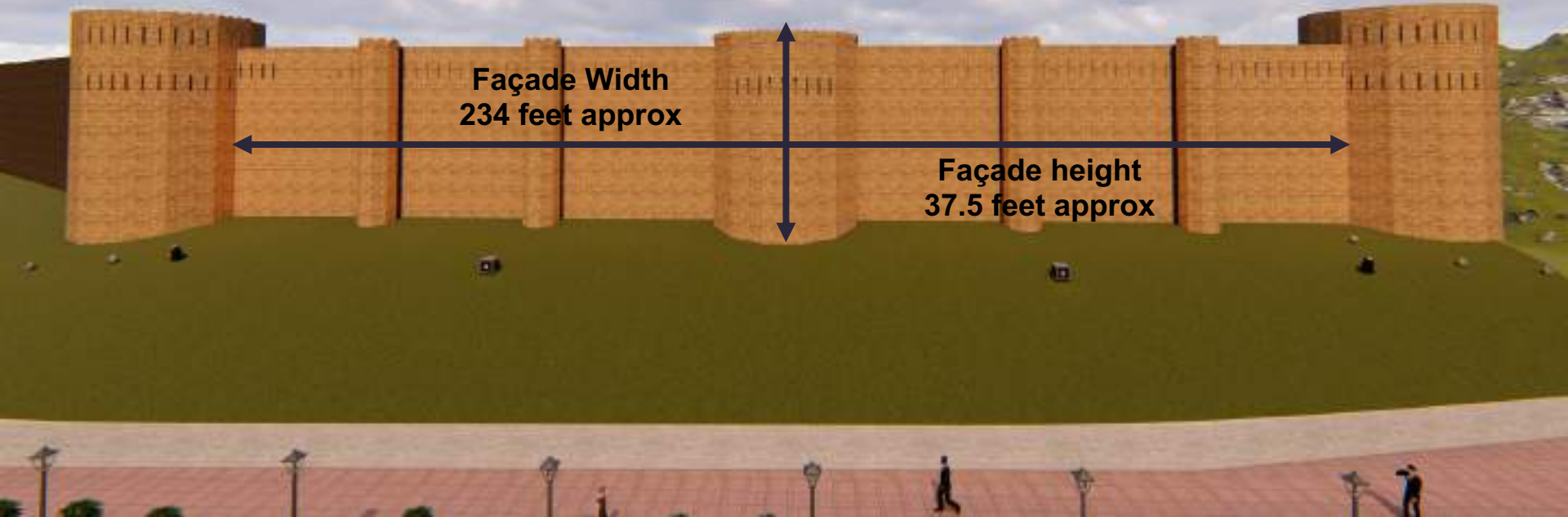

**Façade Width  
234 feet approx**

**Façade height  
37.5 feet approx**

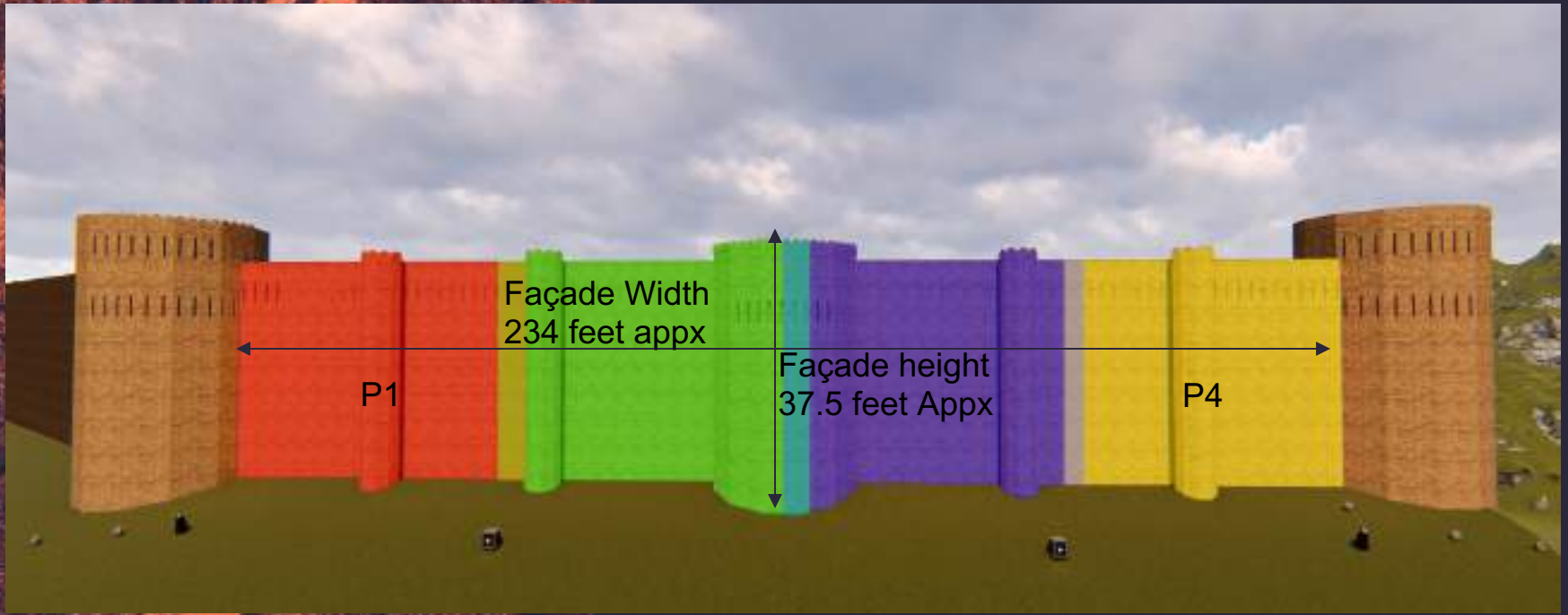

**Façade Coverage Area Through  
4 nos 22000 Lumens Projector**

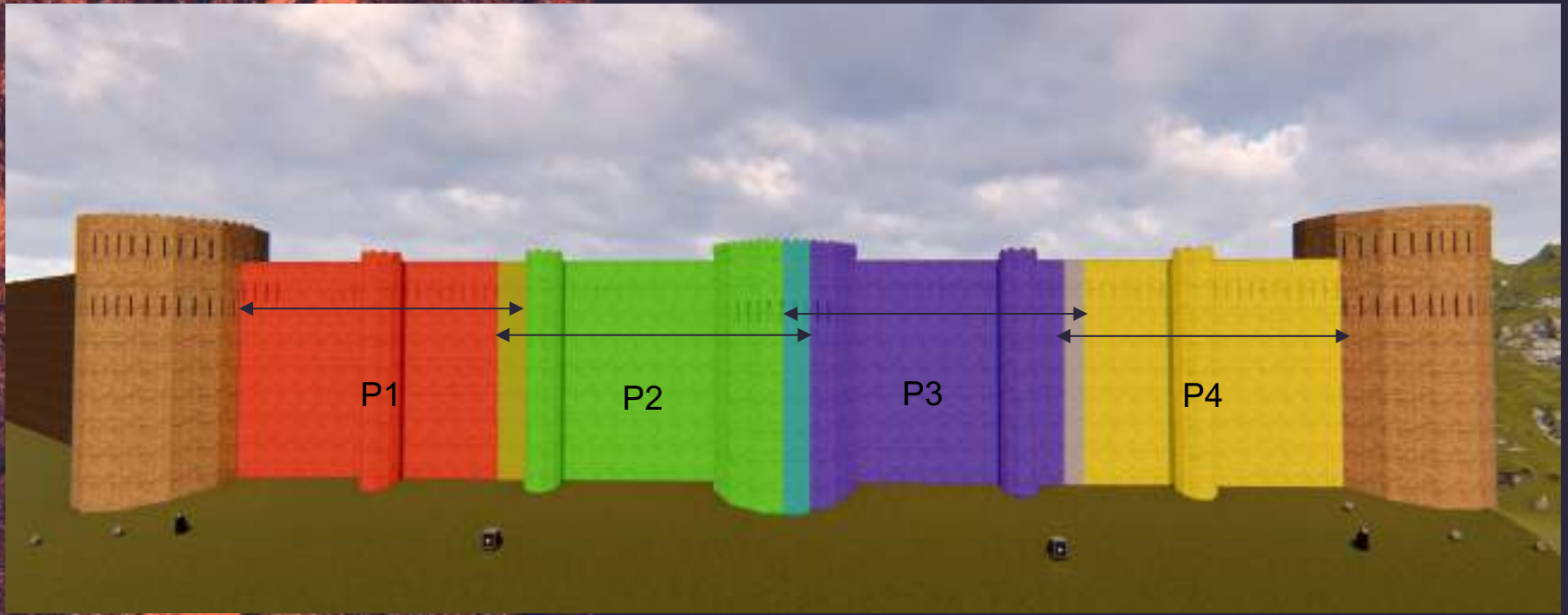

**Façade Dimensions Appx**  
**Total Achievable Brightness – 105 LUX**  
**Minimum Required Brightness for Outdoor – 100 LUX**

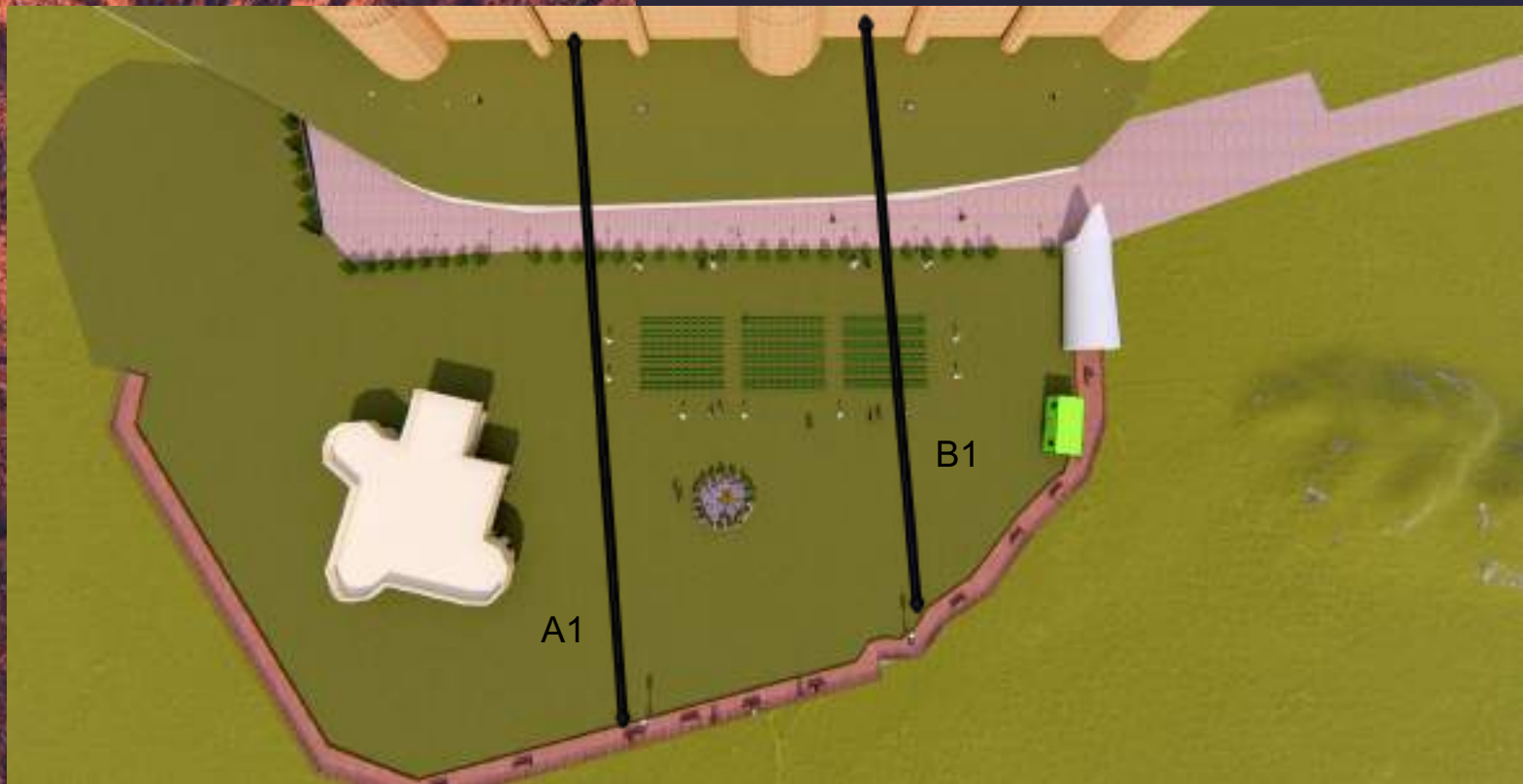

**Projector Distance From Façade**  
**2 nos Projector – A1 75mtr Appx.**  
**2 nos Projector – B1 68mtr Appx.**  
**Required lens Ratio – 2.8-4.5**



**THE TEAM BEHIND  
THIS GRAND SHOW**





**HARISH BHIMANI**  
VOICE OVER ARTIST - HINDI

Recipient of the coveted President's Medal in the National Film Awards 2016, in the category of voice overs/narration, he is the only anchor to have received a Gold Disc from HMV .  
He is enduringly known as the voice of Samay, the narrator of the TV series Mahabharat(BR Chopra).



**JITENDRA RAMPRAKASH**  
VOICE OVER ARTIST – HINDI

Jitendra Ji is one of the known names in Voice industry for over 25years. He is also a poet, philosopher, and educationist. A media-trainer and a former TV & radio news-presenter and a professor of media-studies. He has lent his voice to Audio-books, Documentaries, Light & Sound Shows & Audio-Guides.



**JITENDER SINGH JAMWAL**  
VOICE OVER ARTIST - DOGRI

Son of soil (City of Temples- Jammu) Jitender Singh had already created waves by singing original compositions and ruling the hearts of millions by his voice in Dogri. He owns to his credit many performances, awards, recognitions and positions at national and international level. Having made a mark in the world of music especially in ghazal singing he has also given his voice to Dogri songs, Dogri Voice Over, jingles and bhajans besides given music in scores of films, TV serials, plays and dance dramas.



**AMAN ARORA**

CREATIVE DIRECTOR & SCRIPT WRITER - HINDI

A journalism and mass-communication graduate from Delhi University with over 13 years of experience in creative ventures across a variety of media. He was part of more than 15 Sound and Light Shows across India – Some of Major Projects are:- Jhansi Fort,UP. Valmiki Tirath, Amritsar. Ramalingeshwara Park, Odisha. Meera Bai Smarak, Rajasthan, Dakshineswar



**CHIRAG JAIN**

SCRIPT WRITER

Chirag is one of the known names as a an Indian poet, satirist, humourist and author. He has authored more than 7 books including Koi Yoon Hi Nahi Chubhta, Os, Man To Gomukh Hai, Chhookar Nikli Hai Bechaini. Chirag Jain received the Bhashadoot Samman (award) by the Hindi Academy, Government of Delhi.



**KAJAL GHOSH**

MUSIC DIRECTOR

Kajal Ghosh has received honours including the Sahitya Kala Parishad Award and the NHK Award of Japan. Shri Kajal Ghosh receives the Sangeet Natak Akademi Award for his contribution to theatre music. Recently he composed music for his 15<sup>th</sup> sound and light show project Meera Bai Smarak, Merta city, Rajasthan.



## PRATIK BISWAS

CREATIVE DIRECTOR & SCRIPT WRITER - HINDI

More than 20 (twenty) Son-et-Lumière shows installed at various heritage sites of India including, Purana Quila, New Delhi, Amber Fort, Jaipur, Konark Temple and Dhauli in Odisha, Jhansi fort in U.P., Jallianwala Bag, Jang-e-Azadi Memorial, Punjab and latest Jhansi Sound and light show are an expression of his technical as well as creative ability. He has worked with reputed music labels such as HMV, Warner Brothers, Virgin Records, Music Today, and similar notable brands in more than 100 audio albums of Indian classical, contemporary, and experimental music. /



## NITIN & LOVELEEN

ART DIRECTORS

Nitin & Loveleen both are Bachelor in Arts from DCA. With 20+ years of exceptional track record in visualizing and graphic designing, possessing allied exposure in creative art direction and experiential work. Projects done:  
Projection mapping show at Dakshineswar Temple, Kolkata, Valmiki Temple Projection, Amritsar, LED Pixel Mapping Show, Chhattisgarh, Jhansi Sound and Light show and many more.....

# STORY BACKGROUND



हाल ए बयां जानना हैं अगर बाह का, किसी की जुबानी से,  
तो इसकी कहानियाँ सुनो, आँगन में बहते तवी के पानी से,

**Our Idea was to convert this prodigious fortress into a poetic speaking façade which tells its story and takes us back to the era where it all started**



# Major Points:

## Construction

Raja Jambu Lochan, is said to have built the Bahu Fort

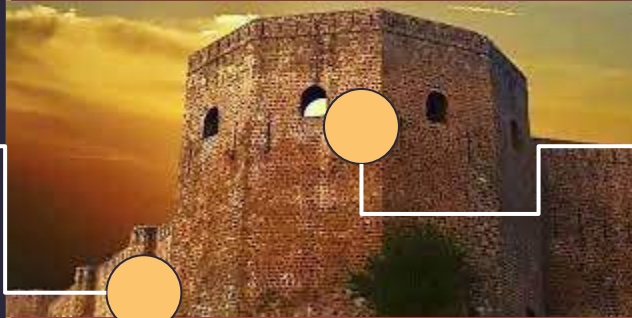

## Fortress Renovation

Last Maharaja Gulab Singh had made many renovations and additions to the fort.

## Dogra Deity's Temple

In the premises of Bahu Fort stands Mahakali, temple of Dogra deity Kalidevi.



## Story of Mahakali

How the goddess said to have got from Ayodhya by the kings before temple construction.

★ **Raja Bahulochan who was the brother of the founder of the city of Jammu, Raja Jambu Lochan, is said to have built the Bahu Fort around 1000 BC on the rocky plateau of the left bank of Tawi called Tuhi in Nilamata Purana.**

★ **It is believed that Raja Jambu Lochan, sibling to Raja Bahulochan and the ruler credited with setting up the city saw an inquisitive sight of a tiger and goat drinking water from the Tawi River, without the tiger attacking the goat. He saw this as a divine sign, one that spelt peaceful coexistence, and decided to establish the city of Jammu here.**

★ **The fort underwent several structural changes in order to retain its strength and beauty, With the passage of time rulers of Jammu region repaired and maintained the Bahu Fort .**

★ **Last Maharaja Gulab Singh had made many renovations and additions to the fort. This fort has seen many battles and many warriors have graced it including Maharaja Gulab Singh and Maharaja Pratap Singh.**

★ In the premises of Bahu Fort stands Mahakali, temple of Dogra deity Kalidevi in black stone, It is believed to have been built during 8<sup>th</sup> century in 1822 a little after the Maharaja Gulab Singh came to power.

★ It is believed that goddess Maha Kali appeared in Pandit Jagat Ram Sharma's dream and spoke about her appearance in the form of a Pindi or stone, buried on the hilltop. Shortly after that a stone was found and a temple was built on the hill.

★ The black stone that is symbolic of the goddess is said to have been got from Ayodhya by the kings belonging to the Solar dynasty, Raja Bahu Lochan and Raja Jambu Lochan much before the temple was constructed.

★ According to the folklore, it is believed that The Dogra royal line trace their descent from Kus, the second son of Rama, and came originally, it is said, from Ayodhya



# MUSICAL TREATMENT

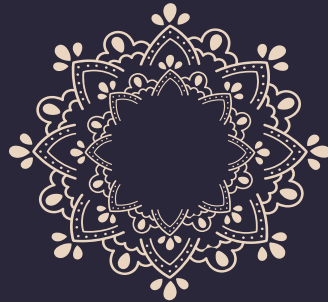

# Use of Traditional Folk Music

We have introduced Folk flavor in the show.

So, the composition of music is based on Rag Pahari, which is commonly sung by artist of Jammu. The music is composed in Dogri Language .

We have tried to include the use of traditional “Kaaraks” of Mata Bawe wali.  
Folk instruments like : Sarangi, Dholak, Flute, Dhol, Kail etc.

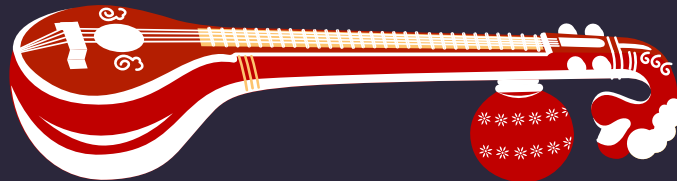



**MOST EXPERIENCE TEAM IN THE FIELD OF SOUND & LIGHT SHOWS**



**ONE STOP SHOP – KNOWLEDGE OF CONTENT GENERATION & SYSTEM INTEGRATION UNDER ONE BANNER**



**HIGH END BILL OF QUANTITIES – SPECIFICATIONS BETTER THAN THE REQUIREMENT**



**LOCAL FLAVOUR – RENOWNED DOGRI ARTIST**



**NOT EVEN TOUCHING THE MONUMENT – HASSLE FREE INSTALLATION – ALSO, KEEP THE SANCTITY OF THE PLACE**

# Thanks

Info@magicaltheatre.in ,  
[aman@magicaltheatre.in](mailto:aman@magicaltheatre.in)

+91 98687 39794

[www.magicaltheatre.in](http://www.magicaltheatre.in)

